

**OWNER'S MANUAL**  
INSTALLATION INSTRUCTIONS

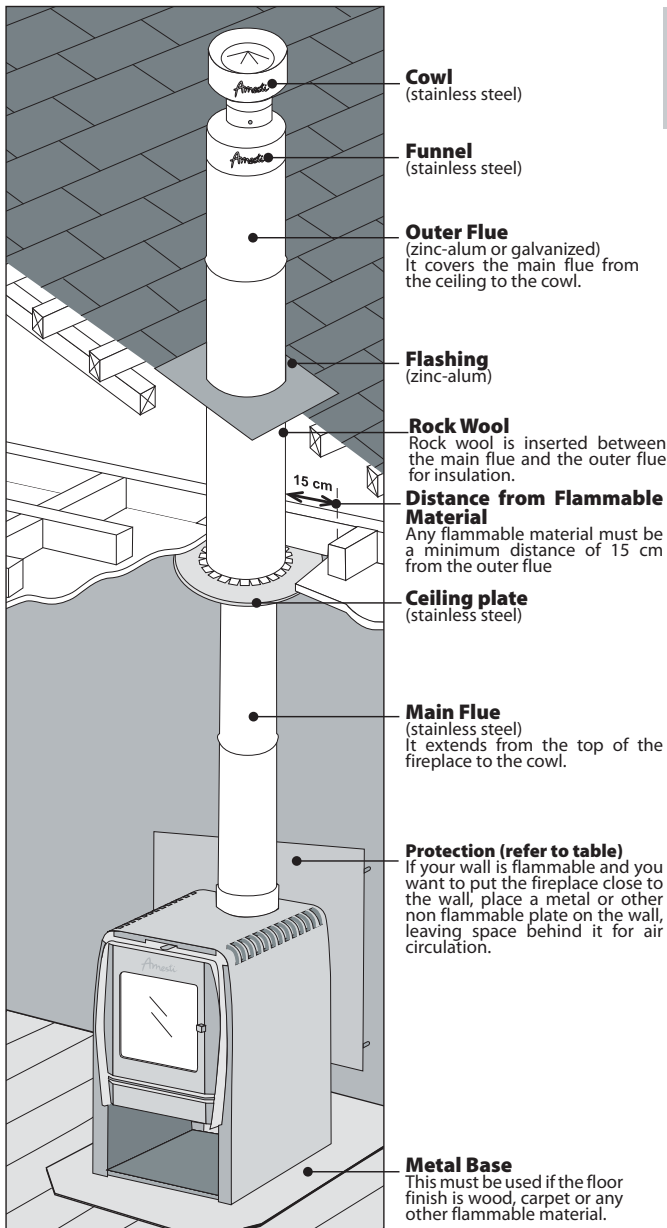

**Amesti**<sup>®</sup>  
CONTEMPORARY FIREPLACES



**THE FLUE PIPES ARE THE MOST IMPORTANT COMPONENTS WITH REGARD TO FIREPLACE SAFETY. THEY MUST BE INSTALLED STRICTLY ACCORDING TO THE INSTRUCTIONS AND KEPT AWAY FROM ANY FLAMMABLE MATERIAL. IN ADDITION, LOCAL BUILDING REGULATIONS AND SAFETY STANDARDS MUST BE RESPECTED.**

1 Choose the location for the fireplace. We recommend that it be positioned close to the center of the room that will be heated. If your floor finish is wood, carpet, plastic or any other flammable material, you must place a steel (or other non-flammable material) base plate under the fireplace. If the wall is made of a flammable material, you must apply the minimum distances shown in the table below. If you want to position the fireplace closer to the wall, you need to protect the wall with a metal or non-flammable plate, 10 cm wider and 30 cm higher than the fireplace itself, and separated from the wall by 3 cm in order to allow free circulation of air.

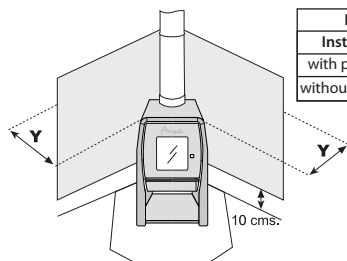

Installation	A	X	Y
with protection	14	7	5
without protection	28	20	15

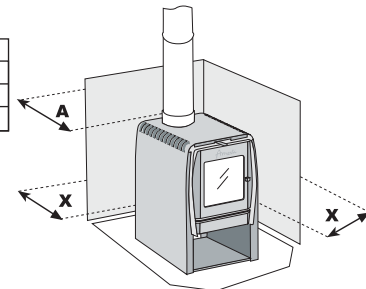

2 Locate the center of the main flue in the ceiling and drill a hole through it and roof. Based on the Flue Kit diameter that you are using, follow the instructions in the table below:

Flue Kit Diameter	Outer Flue	Hole diameter in Outer Roof	Hole diameter in Flammable Ceiling	Hole diameter in Non-flammable ceiling
5"	8"	21 cm	50 cm	21 cm
6"	10"	26 cm	55 cm	26 cm

If the roof is made of wood, the hole must be covered by a sheet of non-flammable material (fibre cement or similar, not included in the Flue Kit). Otherwise, follow the guidelines in the table above closely for the diameter of the holes in the ceiling and roof. In the attic section, place the outer flue over the main flue and fill the space between the main and outer flue pipes with the rock wool supplied. No flammable material should be within a 15 cm range of the outer flue. The outer flue should rest on the ceiling plate and be supported by the roof structure with steel bracing (not provided).

3 The flue pipe should be as straight and vertical as possible. If required, you can use up to two 135° bends. The vertical path should be twice as long as the horizontal. All bends should be after the first length of flue and before the outer flue commences. To ensure optimal performance, the length of the main flue should be between 4 meters and 11 meters in length. Do not place any turnbuckles or regulators on the main flue, since they can alter the fireplace's performance.

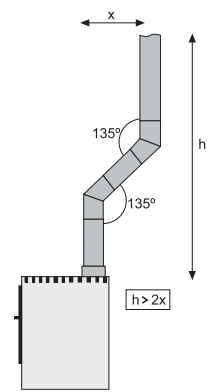

## USE DRY FIREWOOD

Amesti

4 The main flue, cowl and funnel are made of high grade stainless steel. The outer flue and the flashing are made of zinc-alum or galvanized. The main and outer flue sections must be fastened together with stainless steel screws or rivets; use three rivets/screws at each join on both the main and outer flue.

**IMPORTANT:** The main flue pipe unions must be done in such a way that the upper section(s) fits inside the lower one(s). The outer flue section(s) should be done inversely, with the lower section inside the upper.

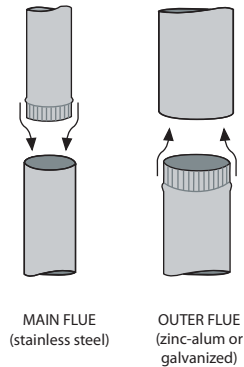

5 The cowl, funnel and the upper edge of the main flue must be screwed or riveted to one another (provided on inside cover of box). The funnel must be free from the outer flue to allow for thermal expansion. **This union must not be screwed/riveted.**

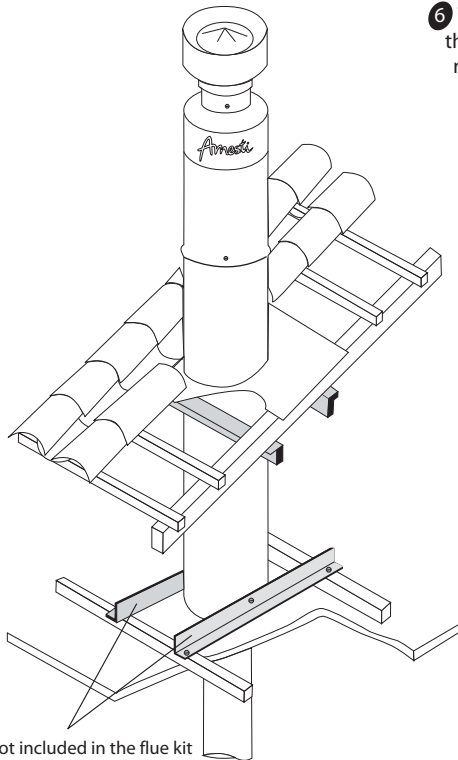
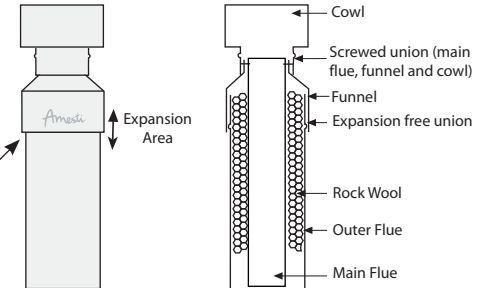

6 You must thoroughly waterproof the flashing where it meets the roof sheeting and where the outer flue goes through the flashing. Consult your hardware or specialist waterproofing company for the most suitable products and techniques.

If the outer flue extends more than one meter above the roof, or if the area is windy, use tension wires to fasten the outer flue to the roof

### USEFUL HINTS

**DOWN DRAFT:** If wind collides with an obstacle, there will be turbulence that can cause smoke to blow back down the flue (down draft). To correct this situation, increase the length of the flue so that it projects over the turbulence area.

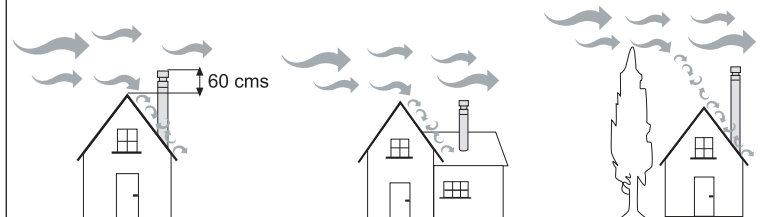

**STAIRCASE:** If the fireplace is positioned near a staircase, the heat will flow towards the upper levels and will not sufficiently heat the lower level. This can be corrected by fixing a lintel above the staircase, thereby distributing hot air around the lower level ceiling.

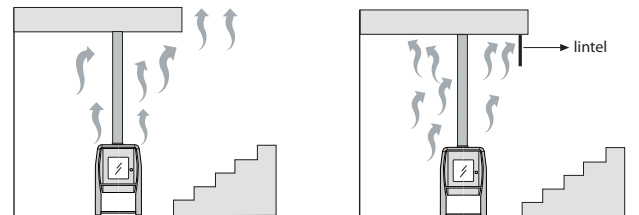

## PRECAUTIONS

- Make sure that your fireplace is installed according to the instructions provided.
- Keep flammable objects away from the fireplace. This includes furniture, firewood, matches, plastic, clothes, etc.
- Be careful when loading firewood inside the fireplace. Do not load firewood when the fire is burning vigorously.
- Use only dry firewood. Avoid using wet or green firewood. Do not use coal.
- Never use gasoline, paraffin, wax, or any other flammable liquid to light or strengthen the fire.
- Do not burn paper or other material that could cause an extremely hot, rapid fire.
- Do not operate your fireplace with the door open, except when lighting it.
- Make sure the door gasket is in place and that the door closes completely
- The fireplace must be used with its damper and refractory bricks installed correctly.

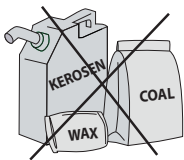

**NOT OBSERVING THESE PRECAUTIONS CAN CAUSE DAMAGES TO OBJECTS AND/OR THE FIREPLACE, THEREBY CANCELLING THE WARRANTY.**

## FIREWOOD

## 1 What kind and amount of firewood should be used?

- Use firewood from eucalyptus, fruit, and other alien invasive trees. Avoid burning indigenous trees, since harvesting can produce irreparable ecological damage. Avoid pine due to its high sap content; sap can accumulate in the main flue and cause a fire hazard.
- It is always advisable to **use dry firewood**. As a general rule, the harder the wood, the better fuel it will make.
- Heat output is controlled not only by the control lever, but also by the type, humidity and amount of firewood placed in the fireplace.
- A full fireplace operating on "HIGH" will generate more heat than one nearly empty on the same graduation.
- Remember, the heat that is generated is equivalent to the calories from the firewood. The more firewood, the higher the heat output.

## 2 How do I obtain dry firewood?

- It is best to purchase firewood during summer and store it in a dry and protected place until you use it. This will enable the wood to dry.
- Purchase firewood on a volume unit basis (cubic meter, square meter, load or truck load), not on a kilogram basis. The reason for this is that wood is heavier when wet, so a seller might prefer to sell you heavy (wet) wood, which increases the selling price.
- A ton of eucalyptus firewood occupies approximately 1 meter base by 2 meters high.

## STARTING THE FIRE

## 1 Before using the fireplace for the first time

- Fit the damper as shown in the section "Fitting the damper" under Maintenance and Cleaning.
- Confirm that the flue is installed according to the instructions.
- When the fireplace is lit for the first time, the fireplace will produce smoke and smell like resin for a few hours. Open the windows to ventilate.

## 2 Lighting the fire

- It is as easy as starting a camp fire.
- Put wrinkled paper in the centre of the fire box.
- Place several wooden chips or sticks on the paper, preferably in a vertical position and put some wrinkled paper on top of sticks.
- Slide the air control lever to "HIGH".
- Light the paper. Once the sticks are burning, carefully open the door and add larger logs (place small logs on the bottom, and larger ones on top).
- Once these logs start to burn, close the door and put the air command control on "HIGH" for about 20 minutes. If the wood is not completely dry, leave the lever on "HIGH" for about 30 minutes.
- When you ignite the fire using this technique, you will create a good base for effective combustion without smoke or pollution.
- When the fireplace reaches operating temperature and there is good draft, place the air command in the desired position. We suggest adjusting the air command slowly before reaching the "LOW" position. Extended combustion occurs when the air command is in "LOW" position.
- It will take some time to familiarize yourself with your fireplace. Never expect an immediate response when sliding the air command lever. Unlike gas fires, solid fuels such as wood have a slow reaction.

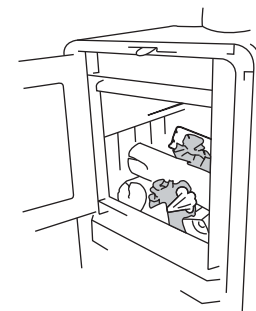

## STARTING THE FIRE

### 3 How to reload your fireplace?

- Open the door and slide the ash tray outwards to catch live coals that may fall. Poke the live coals with a fire hook to remove the ash and place the new wood on top of these coals.
- Never open the door while the fire is burning vigorously. Wait until the fire calms down.
- Slide the air control lever to "HIGH" for a few minutes. Once the flames are vigorous, move the air control lever towards "LOW" to reduce air intake and achieve the desired heat.

### 4 Extended combustion

In order to achieve good combustion throughout the night, do as follows:

- Create a good base of live coal at the bottom of the fire box.
- Load the fireplace with fresh firewood.
- Once the logs start producing flames, set to "LOW".

### 5 How to load your fireplace after an extended combustion?

- After an extended combustion cycle, reset the fire by stirring the live coal under the ashes with a fire hook or steel space, and add some sticks and small logs. Slide the air control lever to "HIGH" and allow the fireplace temperature to recover before adding larger logs.
- Reload your fireplace, as described above.

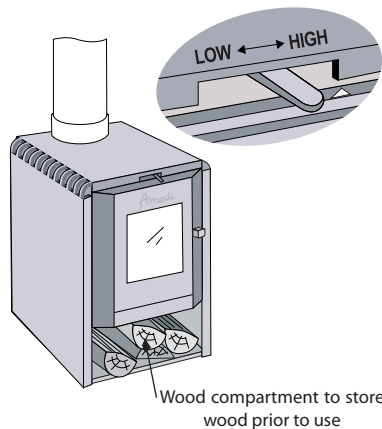

## SCANTOOL AND FIRE TOOLS

### 1 Cold Handle

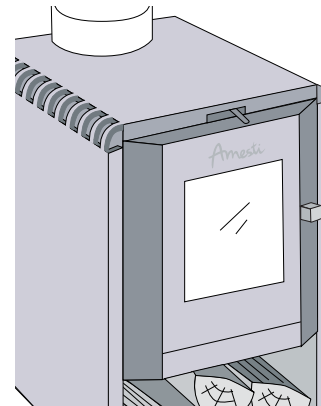

The manufacturer includes a steel handle with each fireplace. This handle must be used to open and close the door, and to move the air control lever.

The handle must be hung in separate place, not on the fireplace. Never leave the handle in the fireplace door.

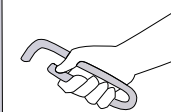

### 2 Shovel

This is not included with the fireplace. Nevertheless, we recommend that you purchase it, since it makes cleaning easier. The shovel is specially designed with straight angles to efficiently reach the corners of the fireplace.

### 3 Fire hook

This is not included with the fireplace. It is very useful for moving logs and lifting coals from under the ashes

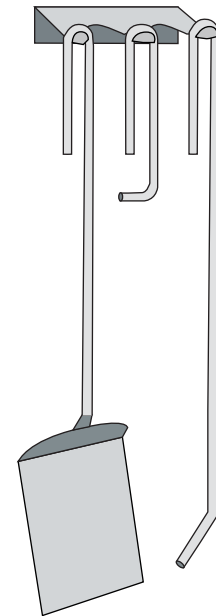

**ASK YOUR DISTRIBUTOR ABOUT THESE TOOLS**

MAINTENANCE

**Removing ash**

- Remove the ash from your fireplace once the level reaches about 2 cm below the lower side of the door's frame.
- Push the pieces of log and coal towards the back part of the fire box.
- Using a small steel shovel, remove the ash and put it into the ash tray. Placing sand in the bottom of the ash tray will reduce the risk of fire. Take the ash out of the house and put it in a safe place. Remember that live coals can burn for up to 36 hours. Untreated wood ash is an excellent fertilizer for your garden.
- Leave at least a 2.5 cm layer of ash as protection for the fire box bottom.

**Glass**

When the fireplace is cold, clean any stain that may appear on the glass with a damp cloth. Avoid using any abrasive material that could scratch it.

**CREOSOTE FORMATION AND THE NEED TO CLEAN THE FLUE**

- Firewood combustion produces acetic and pyro-wood acid, which when combined with humidity, produces creosote. This can settle on the lower walls of the main flue pipes, causing the following problem: Combustion chamber and the flue pipes become blocked, causing the fireplace to malfunction. Under these circumstances, the ignition will be slow, making it difficult to achieve effective combustion. In this instance, clean according to instructions in section "Cleaning Your Wood-burning Fireplace".

PROBLEM SOLVING

Cause of Smoking Fireplace	Solution
No draft due to incorrect ignition	Light the fireplace according to the instructions, using paper and wood chips. Leave the door slightly open until the fires heats up. Slowly add logs. Keep the fire burning.
Wet firewood	Replace the firewood with dry wood.
Blocked flue	Clean the flue (refer to "Cleaning" instructions).
Down draft	- Extend the flue as explained in the installation instructions. - Open a window near the fireplace when starting the fire.
When opening the door to reload the fireplace, smoke may come out from the firebox. This can be reduced by reloading it quickly, opening the door only when needed and using dry wood.	

FITTING THE DAMPER

All Amesti fireplaces are equipped with a unique damper. Some models have a steel damper while others have a Mineral Bioecocaloric® damper. The damper can be easily fitted and removed, enabling one to clean with ease or replace in the event that it wears down. The damper must be fitted in the correct position prior to using the fireplace, as indicated in the diagrams below:

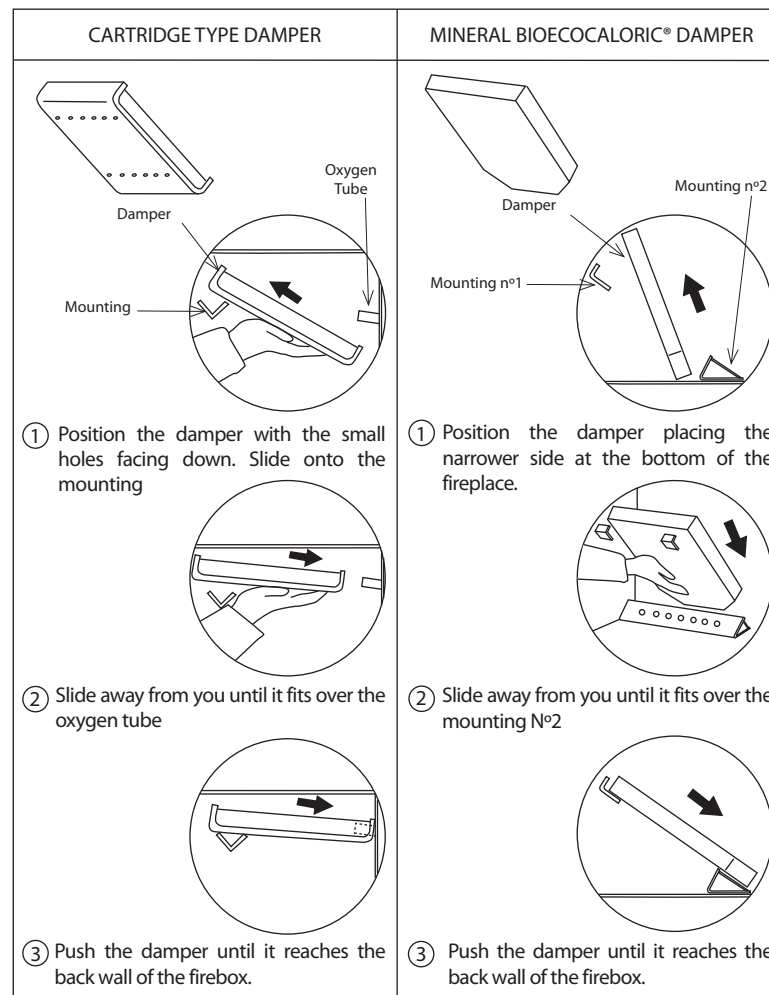

## CLEANING YOUR WOOD-BURNING FIREPLACE

- An advantage of Amesti wood-burning fireplaces is that they can be cleaned without the need to disassemble them.
- Creosote deposits form mostly in the main flue and in the secondary combustion chamber area.
- You can get a professional chimney sweeper to clean the fireplace and flue or do it yourself. If the later, tools required for the cleaning process include a screwdriver, ladder, steel brush, ball, rope and a vacuum.

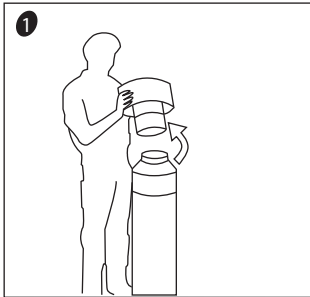

1. Unscrew the cowl and take it off.

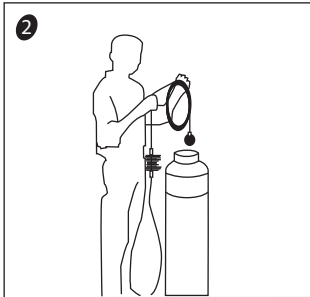

2. Lower the ball and rope from the top of the flue until it is inside the firebox. Remove the damper in the reverse process to that explained in the previous chapter.

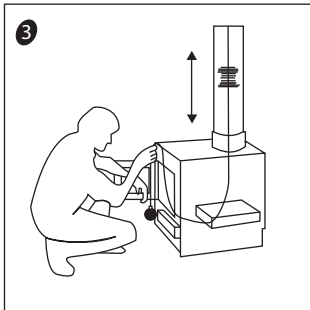

3. Pull the rope from within the fireplace, dragging the steel brush through the inside of the main flue pipes. Then pull the steel brush back upwards and repeat 6 times. Do not use a metal sponge instead of a steel brush

## WARNING REGARDING A CHIMNEY FIRE

Combustion gases can deposit debris such as soot, ash and creosote on the inner walls of the main flue which, under certain circumstances, can cause a fire in the lower part of the main flue. This fire might move progressively up the flue resulting in a fire risk. In this instance, the flue temperature may reach extremely high levels (up to 1000°C) while the deposits on the inner flue walls are burning. This is the greatest risk with fireplaces and is why the flue must be made of a material that resists these temperatures, and that the flue system must be installed correctly.

If an Amesti flue kit has been used and the installation instructions have been followed correctly, the fire risk is significantly reduced, if not eliminated.

### What to do in case of chimney fire?

- Keep calm. A chimney fire will last until the deposited material on the flue walls burns out. This takes between 5 and 20 minutes.
- Close the fireplace door. Do not open it under any circumstances, not even to extinguish the fire, or to take out the logs.
- Move the air control lever to the "LOW" position.
- Closely watch the material closest to the flue. If it starts smoking, cool it frequently with a wet cloth.
- If you can reach the attic, remove any flammable materials that might be in contact with, or too close to, the outer flue.
- Watch the flue outlet on the roof. If sparks come out of the cowl, immediately wet the roof around the flue.

### How to avoid chimney fires?

- Use only dry wood.
- Never leave the fireplace door open for extended periods when a fire is burning.
- Avoid low smoky fires – ensure vigorous combustion prior to setting the fire to extended combustion.
- Clean the flue at least once a year.



**Amesti**<sup>®</sup>  
CONTEMPORARY FIREPLACES

AMESTI LTDA.

---

J.M. Carrera 6, Barrio Industrial Los Libertadores  
Colina, Santiago, Chile • P.O. Box: 9340000

---

Fono (56-2) 798 0000 • Fax (56-2) 798 0030 • [www.amesti.cl](http://www.amesti.cl)

---